

# How to Get Around NESFA®

## Welcome to the New England Science Fiction Association (NESFA)!

Our mission is to promote Science Fiction. We host a yearly Science Fiction convention (Boskone®). We also publish books (NESFA Press). We have a clubhouse where we maintain a library of over 20,000 books, magazines, and videos which you, as a member, may borrow. In our clubhouse, we also host activities such as a Reading Group, Game Day, and Media Day; and hold work sessions and Business Meetings. As we are entirely a volunteer organization, we are always looking for people to join in our activities.

Some more information can be found at:

For NESFA: <https://www.nesfa.org/>

For Boskone: <https://www.boskone.org/>

For NESFA press: <https://www.nesfa.org/press/>

We have put together this guide to help new folks interact and get things done. Just as fish are so used to the characteristics of water that they don't realize that they react differently to it than air-breathers, most long-term NESFAns are not usually aware of some of the oddities of NESFA practice. However, most NESFAns are more than happy to explain anything and everything to anyone who asks. If you don't get an understandable answer from the first person you ask, you can always ask "who knows more about this?" Most NESFAns think curiosity is a great virtue almost independent of what one is curious about.

### 1. Borrowing Books from the Library

All NESFA Members of all classes can borrow books, magazines, and DVDs from the library. Please ask a member of the Library Committee for a library card. If you have access to the computer system, you can self-checkout an item. If you do not have access, ask how to get it.

### 2. Groups Which Often Meet at the Clubhouse

There are several groups which usually meet. Check The NESFA Calendar (Section 3.) for dates. All events are free to attend and you don't have to be a member.

#### 2.1. The Reading Group

Civil book discourse expands and enriches the reading experience of everyone. Join our cadre of like-minded adventurers for an enjoyable evening of discussion and insights. While we love movies and TV and we may compare or contrast a book with its other media versions, our discussions focus on the book. The Reading Group meets monthly. We read and discuss science fiction and fantasy novels, novellas, and the occasional short story collection.

#### 2.2. NESFA Writes: A Maker Space for Making Fiction

This is a quiet time to help you make your goals, meet your deadlines and accomplish your dreams. It is not a critique group and is not a session for collaboration

### 2.3. Playing Games

We play short games, long games, easy games, hard games, complicated games, and even a few no-brainers. Fan favorites as well as rare or hard-to-find games are available. Game days usually run twice a month except for January and February, from noon to midnight. There are also video games; A Wii, PS4, 360, and XBOX1. There's never any fee or cost to play a game and you don't have to be a member. All you have to do is open the door and have fun!

### 2.4. Watching Video Media

We project a computer display, DVD player, or stream media onto our screen. Please note that there are rated R movies in the clubhouse that will be shown from time to time. Although there is a general rule that no adult material will be shown in the clubhouse, there are exceptions. In those instances, no one under 18 would be allowed in the clubhouse. There is no cost or fee to come in during a Media Day and you do not have to be a member. Media Days are usually run once a month. Check out the Calendar (Section 3.) for times. If you must arrive late, please enter through the back door (accessible through our parking area off Lowell Street) so you don't interrupt the program.

### 2.5. Special Events

Because of all those games and all those DVDs, NESFA runs some special events each year. The ones below usually happen every year. All are free to attend and you don't have to be a member.

- Hugo Viewings – All shows nominated for a Hugo Award in the Short and Long Programs will be watched in their entirety at the clubhouse over a series of weekends from May to July.
- Hugo Award Ceremony screening – The Media day for August/September is on the same day as the Hugo Award Ceremony at Worldcon.
- Halloween Party – The Sunday before Halloween (or Halloween itself if it's on a Sunday), the Other Meeting (Section 6.2.) is annually held at the clubhouse, which will be filled with all manner of sweets and candies.
- Turkeyfest – This is held the Saturday (and sometimes Sunday) after Thanksgiving. On these days, be prepared to test your mettle as a continuous stream of the most horrible movies you've ever seen in your life are shown. Lots of laughs and lots of groans.
- Annual Bah Humbug Game Festival – This is held Xmas Eve and Xmas, with nothing but games, noon to midnight on Xmas Eve and 2pm to midnight on Xmas.

### 3. The NESFA Calendar

If you want to find out when various events, including the Reading Group, Game Day, and Media day occur, the best place to look is the official NESFA Calendar:

<https://www.nesfa.org/events/>

Events are often also listed in “social media” such as MeetUp and FaceBook. However, all events must be listed on the NESFA Calendar before listing on those places, to avoid conflicts.

### 4. *Instant Message*

*Instant Message* (IM) is the name of the NESFA newsletter. It is issued to all Members at least once a month by the Clerk and contains the minutes of all Business Meetings of the Membership. All NESFA Members may receive the *Instant Message*. The name actually comes from the Cordwainer Smith Instrumentality stories. In these stories instant messages were Faster Than Light but were not often used because of the expense. You can elect to receive a paper copy through the US mail, a PDF copy via the Internet, or both. The PDF copy usually is out fairly quickly after a Business Meeting (Section 6.2.); but not in an instant.

### 5. NESFA E-Mailing Lists

NESFA maintains many e-mailing lists, each with a specific purpose. A listing of all the mailing lists is on:

<https://www.nesfa.org/resources/mailling-lists/>

Most lists have various criteria for inclusion. To request inclusion on a list, click on the list name on the web-page above.

### 6. Classes of Membership, Voting Rights, and Meetings

#### 6.1. Classes of Membership, and Voting Rights

NESFA has found it convenient to have several classes of membership. You might be interested in knowing the various classes of membership from the NESFA By-laws, located at <http://www.nesfa.org/rules/Bylaws.html#b11> .

[Please note that these classes could change in the future. If you receive our *Instant Message* (IM), the details of any changes will be described there.]

Here is a summary of classes of membership in NESFA:

(a) Regular, which, except as otherwise provided, entitles its holders to all rights, privileges, and duties of active membership in NESFA, and which constitutes the only class of voting membership at Business Meetings. For other types of meetings the chair may make a ruling on who can vote.

(b) Inactive, which entitles its holders to all rights and privileges of membership in NESFA except voting rights. Inactive Membership is reserved for former Regular Members.

(c) General, which, except as otherwise provided, entitles its holders to all rights and privileges of membership in NESFA except voting rights.

[Note: General Members usually are those who have participated somewhat in club activities, and have often come to Business Meetings.]

(d) Subscribing, which, except as otherwise provided, entitles its holders to receive the generally distributed publications and notices of NESFA, and to such other rights and privileges as may be specified by NESFA.

(e) Affiliate, which is limited to organizations and, except as otherwise provided, entitles its holders to receive the generally distributed publications and notices of NESFA and to such other rights and privileges as may be specified by NESFA.

(f) Family-Dependency, which entitles its holders to the same rights and privileges as General Membership, except the right to receive, independently, the publications, notices, and other mailings sent to the sponsoring Member. Any Regular, Inactive, General, or Subscribing Member may sponsor their cohabitants and immediate relatives for Family-Dependency Membership.

It is best to ask an Officer or Membership Committee member about how to change classes of membership. Details (probably more than you want to know) can be found throughout the “NESFA By-Laws” and the “NESFA Standing Rules”:

<https://www.nesfa.org/rules/>

## 6.2. Meetings

NESFA Business Meetings occur every month, except during the summer, when the July and August meetings are often combined. The dates and times of meetings are given in the Calendar described in Section 3.. All NESFA members are encouraged to attend these meetings, but, as explained above, only Regular Members can vote.

NESFA Business Meetings are run following Robert's Rules of Order with a few odd conventions added. Anyone who raises their hand and is recognized by the chair may speak no matter their membership class, so though not everyone has a vote, everyone has a voice. This will add such phrases as "point of information" (a question you wish to ask), "point of personal privilege" (non-business request such as turn up the heat), "point of order" (this is not the correct point in the meeting to discuss this, what is being discussed is not something that is our business, incorrect parliamentary procedure, or "the meeting will come to order"), and "ultra vires" (above the power or purview of the organization).

NESFA also holds "Other Meetings"; usually each month, a different weekend than the Business Meeting, for socializing and informal discussions.

## 7. NESFA By-Laws and Standing Rules

Like any other organization, NESFA has a set of By-Laws and Rules. Most of these concern the business of NESFA as carried out by its Executive Board, the Committees, and at Meetings; as described in Section 6..

If you are interested in knowing considerably more detail, the "NESFA By-Laws" and the "NESFA Standing Rules" can be found at:

<https://www.nesfa.org/rules/>

## 8. Dues

If you join, please do pay your dues. The dues for each class of membership are determined by the membership; and are given in the membership application form and should be in the latest version of the Standing Rules:

<https://www.nesfa.org/rules/SR.html#sr2.1:1>

Dues are due annually, from the time the dues were first due. A Member newly admitted shall be dropped from membership if he or she has not paid his or her dues within one month from the date of admission. Any other Members whose dues remain in arrears at the end of the calendar month after the one in which those dues were due shall be dropped from membership at that time, unless "special circumstances" apply (such as financial hardship.)

## 9. NESFA Management.

As a Member, you might interface with some NESFA Officers and committees. Since it is an all-volunteer organization, all Officers and committee members are unpaid volunteers

The Officers of NESFA are: President ( [president@nesfa.org](mailto:president@nesfa.org) ), Vice President: ( [vice-president@nesfa.org](mailto:vice-president@nesfa.org) ), Treasurer: ( [treasurer@nesfa.org](mailto:treasurer@nesfa.org) ) and Clerk ( [clerk@nesfa.org](mailto:clerk@nesfa.org) ). The Executive Board consists of the Officers. Email can be sent to all four officers at once at [eboard@nesfa.org](mailto:eboard@nesfa.org).

In addition, NESFA has several Committees. Among there are; Rules Committee, Membership Committee, Finance Committee, and Clubhouse Committee. Detailed descriptions of what these and other Committees do can be found at:

<https://www.nesfa.org/committees/>

#### 10. The Clubhouse

The NESFA Clubhouse is the focus of most NESFA events. Located at 504 Medford Street, Somerville, MA 02145; we gather almost every Wednesday evening. We work on various group or individual projects. We also hang out and schmooze, or play games. The telephone number is 617-625-2311 (Note: There usually is no one at the Clubhouse to answer it, and the call will usually go to voicemail.) The general email address is [info@nesfa.org](mailto:info@nesfa.org). Although our Clubhouse is in Somerville, all Postal mail should be sent to: NESFA, PO Box 809, Framingham, MA 01701-0809.

For more information on the history of the clubhouse, and how to get there via automobile or bus, please see:

<https://www.nesfa.org/clubhouse/>

A diagram of the clubhouse and its environs is shown next.



Medford Street

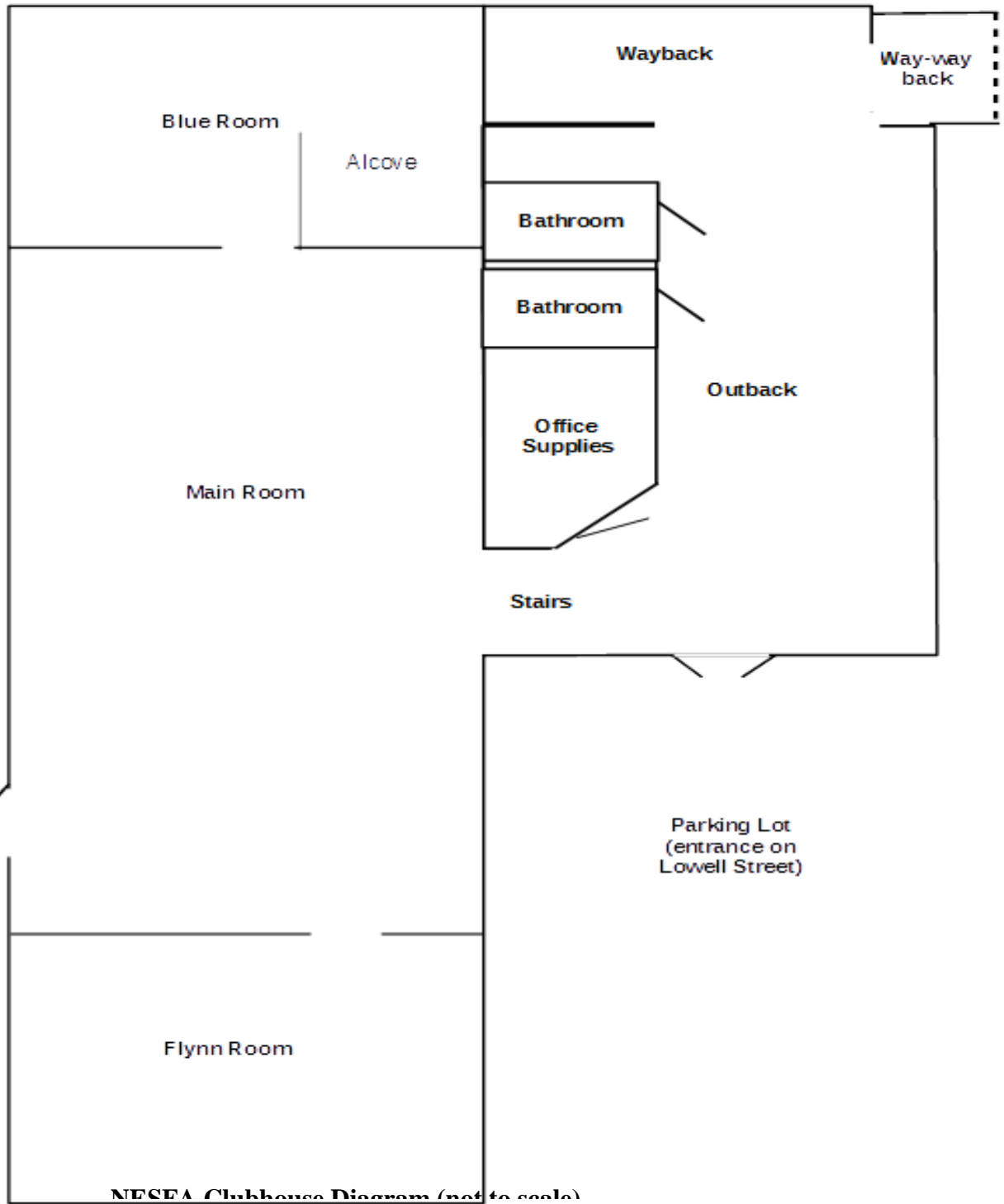

NESFA Clubhouse Diagram (not to scale)

Like any other meeting place, there are some simple, hopefully obvious rules to follow.

- Keep all unattended food and anything else a rat might want in a container which a rat cannot gnaw through. This usually means the refrigerator. Put all food waste, as well as other refuse, in the large blue container marked “food”.
- If you visit our bathrooms, you might notice their low altitude. This means that flushes have a hard time reaching the sewer below the street. Always take the time to let the toilet tanks be full before flushing. Flush the number of times instructed on the signs.
- You also might have noticed our parking lot is very small. The parking lot is reserved for NESFA members and guests present on official NESFA business or events (and also for our neighbors). One exception is if someone must leave their car at the clubhouse for NESFA business (for example, if they are driving a truck someplace for NESFA), they should leave the car keys with someone at the clubhouse, if available.
- Heating in the winter and air conditioning in the summer, and lighting year-round cost money; which NESFA does not have much of. The clubhouse can only be used for official NESFA business or events. For permission to hold non-NESFA events there, check with the Executive Board (Section 9.)
- Chairs are for sitting in. Hang coats and jackets on hooks and put other things (besides yourself) in unobtrusive locations.
- Our two refrigerators (near the entrance to the Blue Room) have soda and bottled water. After drinking, wash out the soda cans and place empty cans and bottles in their bins in the Blue Room near the door.
- The usual rules on avoiding distracting noise and other distractions to other members apply.
- Do not use scotch tape to hang signs at the clubhouse. Scotch tape is hard to remove; use blue tape instead.

## 11. Boskone

Boskone is a classic science fiction convention which is held annually (usually over President’s Day weekend). It features some of the best authors, editors, artists, and musicians in the science fiction community. Typically; approximately 1,200 fans and pros who love SF & fantasy come for a weekend filled with fun, wisdom, and knowledge,

For the latest news; please go to: <https://www.boskone.org/>

## 12. NESFA Press

NESFA Press, our publishing arm, is a highly-regarded science fiction press. NESFA has won awards for its effort to keep essential classics in print.

To find the latest publications available; please go to: <https://www.nesfa.org/press/>